



PIPE

Water is an important factor in crop cultivation. This is an important factor of the plant growth both in the quality and quantity of output. Some areas have limited of water and insufficient water. Drip Irrigation System is an important role in water management and save of water usage. Water Pipe is an important in transporting and throughout the plots. There are many types of Water Pipe depending on the area and the water requirements of plants.

LDPE PIPE

Used as a pipe in agriculture work, water drip system, nozzle spray or termites insecticide chemical system. Resistant to the environment. Suitable for low pressure work.

Features :-

1. Not fragile and no break easily
2. Long lifetime and UV protection coating on surface
3. Smooth surface, light weight and well bend bendable
4. Manufactured in accordance with international Standards DIN 8072/73



Size mm. (inch)	Length (meter)	PN 3.2 (White Strip)	
		Code Number	
16 (3/8")	20	398-16-2(PN3.2)	
	100	398-16-1(PN3.2)	
	200	398-16(PN3.2)	
20 (1/2")	20	398-20-2(PN3.2)	
	100	398-20-1(PN3.2)	
	200	398-20(PN3.2)	
25 (3/4")	20	398-25-2(PN3.2)	
	100	398-25-1(PN3.2)	
	200	398-25(PN3.2)	
32 (1")	100	398-32-1(PN3.2)	
	200	398-32(PN3.2)	

HDPE PIPE

Used in water system transmission of high pressure works e.g. main water pipes of the water system or other electrical wiring.

Features :-

1. Not fragile and no break easily
2. Long lifetime and UV protection coating on surface
3. Smooth surface, light weight and well bend
4. Manufactured in accordance with international Standards DIN 8072/73



Size mm. (inch)	Length (meter)	PN 4 (Orange Strip)	PN 6.3 (Orange Strip)
		Code Number	Code Number
16 (3/8")	100	398-16-1(PN4)	-
	200	398-16(PN4)	-
20 (1/2")	100	398-20-1(PN4)	-
	200	398-20(PN4)	-
25 (3/4")	100	398-25-1(PN4)	-
	200	398-25(PN4)	-
32 (1")	100	398-32(PN4)	398-32(PN6.3)
40 (1 1/4")	100	398-40(PN4)	398-40(PN6.3)
50 (1 1/2")	100	398-50(PN4)	398-50(PN6.3)
63 (2")	50	398-63(PN4)	398-63(PN6.3)
75 (2 1/2")	50	-	398-75(PN6.3)
90 (3")	50	-	398-90(PN6.3)
110 (4")	50	-	398-110(PN6.3)



Lay-Flat Hose

Used to transmit the water from the water source to the farm and field for drainage flood. Suitable for agricultural work, construction work and irrigation work.

Features : light weight, easily to fold and durable.



PE Lay-Flat Hose (Black)

Code Number	Size (inch)	Length (meter)	Pack Size (box)
6-034B	3/4"	100	1
6-010B	1"	100	1
6-012B	1 1/2"	100	1
6-020B	2"	100	1



PE Lay-Flat Hose (White)

Code Number	Size (inch)	Length (meter)	Pack Size (box)
6-034S	3/4"	100	1
6-010S	1"	100	1
6-012S	1 1/2"	100	1
6-020S	2"	100	1
6-030S	3"	100	1
6-040S	4"	100	1



Lay - Flat Hose (2 Bar)

Code Number	Size (inch)	Length (meter)	Pack Size (box)
6-015L	1 1/2"	100	2
6-020L	2"	100	5
6-025L	2 1/2"	100	4
6-030L	3"	100	3
6-040L	4"	100	2
6-060L	6"	100	1



WP : 2 Bars
odor-less



WP : 4 Bars
odor-less

PVC Lay-Flat Hose (2 Bars)

Code Number	Size (inch)	Length (meter)	Pack Size (roll)
6-PVC01 1/2-2CP	1 1/2"	100	1
6-PVC02-2CP	2"	100	1
6-PVC02 1/2-2CP	2 1/2"	100	1
6-PVC03-2CP	3"	100	1
6-PVC04-2CP	4"	100	1
6-PVC05-2CP	5"	100	1
6-PVC06-2CP	6"	100	1
6-PVC08-2CP	8"	100	1

Lay-Flat Hose (4 Bars)

Code Number	Size (inch)	Length (meter)	Pack Size (roll)
6-PVC01-1/2-4CH	1 1/2"	100	1
6-PVC02-4CH	2"	100	1
6-PVC02-1/2-4CH	2 1/2"	100	1
6-PVC03-4CH	3"	100	1
6-PVC04-4CH	4"	100	1
6-PVC05-4CH	5"	100	1
6-PVC06-4CH	6"	100	1
6-PVC08-4CH	8"	100	1



WP : 2 Bars



WP : 4 Bars

PVC Lay-Flat Hose (2 Bars)

Code Number	Size (inch)	Length (meter)	Pack Size (roll)
6-PVC01 1/2-2CP(B)	1 1/2"	100	1
6-PVC02-2CP(B)	2"	100	1
6-PVC02 1/2-2CP(B)	2 1/2"	100	1
6-PVC03-2CP(B)	3"	100	1
6-PVC04-2CP(B)	4"	100	1
6-PVC05-2CP(B)	5"	100	1
6-PVC06-2CP(B)	6"	100	1
6-PVC08-2CP(B)	8"	100	1

PVC Lay-Flat Hose (4 Bars)

Code Number	Size (inch)	Length (meter)	Pack Size (roll)
6-PVC01-1/2-4CH(B)	1 1/2"	100	1
6-PVC02-4CH(B)	2"	100	1
6-PVC02-1/2-4CH(B)	2 1/2"	100	1
6-PVC03-4CH(B)	3"	100	1
6-PVC04-4CH(B)	4"	100	1
6-PVC05-4CH(B)	5"	100	1
6-PVC06-4CH(B)	6"	100	1





Hole Punch for Lay Flat Hose

Code Number	Size (mm)	Pack Size (bag)
350-199	16-20	100



Lay Flat Hose Connector Female Thread

Code Number	Size (inch)	Pack Size (bag)
350-140C	1/2"-3/4"	100



Punching for Lay - Flat Hose

Code Number	Size (mm.)	Pack Size (box)
399-LF	16	1



Lay - Flat Connector-Drip Tape

Code Number	Type	Size (mm)	pack Size (bag)
350-141C	Flat	16.5	100



Drip Tape Valve - Lay flat

Code Number	Size (mm)	Pack Size (bag)
387-141C	16.5	100



Sprayer Tape Valve - Lay flat

Code Number	Size (mm x inch)	Pack Size (bag)
388-88	35x1/2"	100
388-89	43x3/4"	100

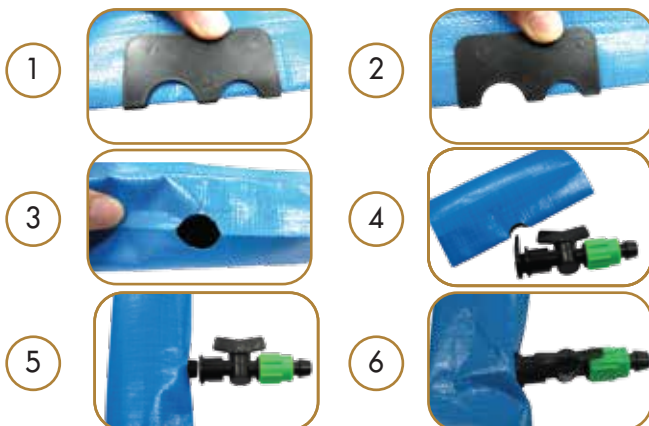

TIPS

How to use Hole Punch for Lay Flat Hose

1. Fold the Hole Punch for Lay Flat Hose attached to the Lay Flat Hose or transmission line.
2. Cut groove by using sharp cutter

Hose

In accordance with production standard, transparent, soft tubing and good quality.



PVC Flexible Hose (Blue)

Code Number	Size (inch)	Weight (kg)	Length (meter)	Pack Size (roll)
6-212B	1/2"	12	100	1
6-258B	5/8"	17	100	1
6-234B	3/4"	24	100	1
6-201B	1"	22	50	1
6-201B-1	1"	44	100	1



PVC Water Hose (Transparent)

Code Number	Size (inch)	Weight (kg)	Length (meter)	Pack Size (roll)
6-212S	1/2"	12	100	1
6-258S	5/8"	15	100	1
6-234S	3/4"	20	100	1
6-201S	1"	12.5	50	1
6-201S-1	1"	25	100	1



Suction Hose

The Suction Hose is smooth surface and hose wall is strong. Resistant to the suction pressure of the pump. Use to connect the pond. Suction Hose is flexible, can be bent easily, light weight and easy to move. Can be used with Foot Valve.



PVC Suction Hose Chaiyo (Red)

Code Number	Size (inch)	Length (meter)	Pack Size (roll)
6-125(12M)	1"	12	1
6-125(24M)	1"	24	1
6-130(12M)	1 1/4"	12	1
6-130(24M)	1 1/4"	24	1
6-140(12M)	1 1/2"	12	1
6-140(24M)	1 1/2"	24	1
6-150(8M)	2"	8	1
6-150(12M)	2"	12	1
6-150(24M)	2"	24	1
6-165(12M)	2 1/2"	12	1
6-165(24M)	2 1/2"	24	1
6-175(8M)	3"	8	1
6-175(12M)	3"	12	1
6-175(24M)	3"	24	1
6-200(8M)	4"	8	1
6-200(12M)	4"	12	1



TIPS

How to install Suction Hose

